

41 190 000 **FITTING COMBINATION 1/2"**

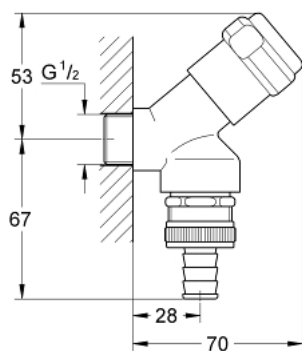

**TOOTE KIRJELDUS**

- Värvus: chrome
- wall mounted
- slanted seat model
- with safety unit type HD (pipe ventilating valve combined with non-return valve)
- grease chamber headpart 1/2" for closable hose connection
- protected against backflow
- GROHE Long-Life finish



## 41 190 000 **FITTING COMBINATION 1/2"**

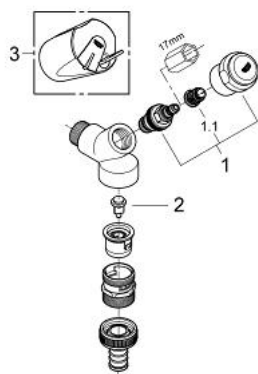

### **VARUOSAD**, juuni 2006 – nüüd

1: Headpart 1/2" (Tellimuse number 41818000)

1.1: Snap insert (Tellimuse number 4184200M)

2: Cone (Tellimuse number 41835000)

3: Handle (Tellimuse number 41000000)\*

\* Lisatarvikud