

## 39 648 SH0 **BAU CERAMIC MANUAL BIDET SEAT**

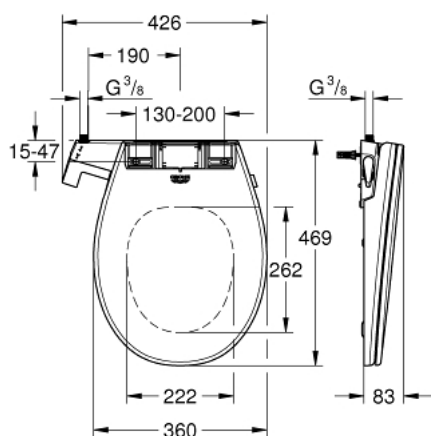

### TOOTE KIRJELDUS

- Värvus: alpine white
- WC seat with lid
- 2 dedicated spray arms (1 for anal area, 1 for lady spray)
- pre- and post-rinsing of spray nozzle with fresh water
- manually operated side handle requires no electricity
- Duroplast WC seat and lid with soft close function
- flexible water connection 3/8"
- includes:
  - mounting plate
  - filter
  - pressure 0.1 - 1.0 MPa (1 - 10 bar)
  - complies with EN 1717

## 39 648 SH0 **BAU CERAMIC MANUAL BIDET SEAT**

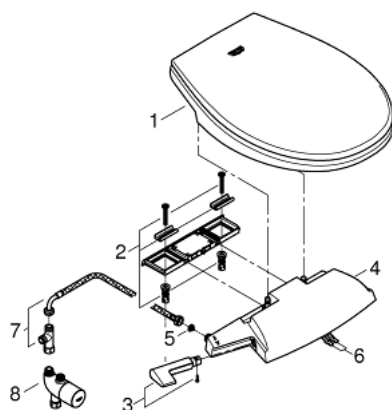

### **VARUOSAD**, jaanuar 2019 – nüüd

- 1: WC seat and lid (Tellimuse number 14986SH0)
- 2: Fastening (Tellimuse number 14989000)
- 3: Lever (Tellimuse number 14988F00)
- 4: Operating unit (Tellimuse number 14987SH0)
- 5: Filter (Tellimuse number 4241300M)
- 6: Spray set (Tellimuse number 14990000)
- 7: Accessory set shower hose and T piece (Tellimuse number 14074000)\*
- 8: Thermostatic scalding protection (Tellimuse number 34487000)\*

\* Lisatarvikud