

## 38 784 P00 **SKATE COSMOPOLITAN ACTUATION PLATE**

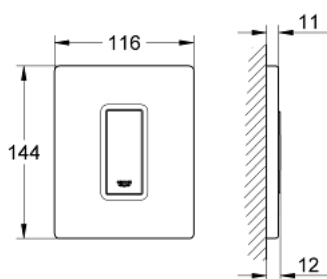

### TOOTE KIRJELDUS

- Värvus: matt chrome
- manual activation for urinal
- set for final installation
- for Rapido U or Rapido UMB
- 116 x 144 mm
- mechanical functional cartridge
- flow pressure min 0.5 bar
- operating pressure max 6 bar
- 1.0 - 6.0 l adjustable
- low noise (group II according to German noise specification)
- GROHE Long-Life finish



## 38 784 P00 **SKATE COSMOPOLITAN ACTUATION PLATE**

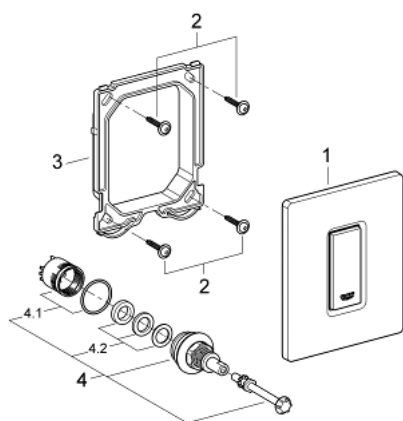

**VARUOSAD**, märts 2012 – nüüd

1: Top plate with push button (Tellimuse number 42377P00)

2: Screw (Tellimuse number 6636200M)

3: Mounting frame (Tellimuse number 66845000)

4: Cartridge (Tellimuse number 42354000)

4.1: Seal kit (Tellimuse number 4271500M)

4.2: Rings (Tellimuse number 4282000M)