

38 661 000 FLUSHING CISTERN GD 2

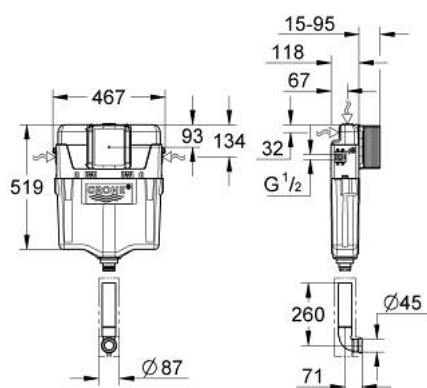

TOOTE KIRJELDUS

- Värvus: chrome
- 6 - 9 l adjustable
- adjustment ex factory 6 l and 3 l
- pneumatic discharge valve offering 3 modes of operation: dual flush or start/stop or single flush
- water supply from left/right/back or top
- low noise (group I acc. to German Noise Specification)
- insulated against condensation
- 1/2" water supply connection including integrated angle valve and push fit flexible hose union
- no tools required for the installation of the inspection shaft incl. protection during construction phase
- flush pipe insulated against condensation
- fixing brackets
- without wall plate/actuation
- GROHE Water Saving - Less water, perfect flow
- for mounting of small flush plates please order revision shaft 40 911 000 (sold separately)

38 661 000 FLUSHING CISTERN GD 2

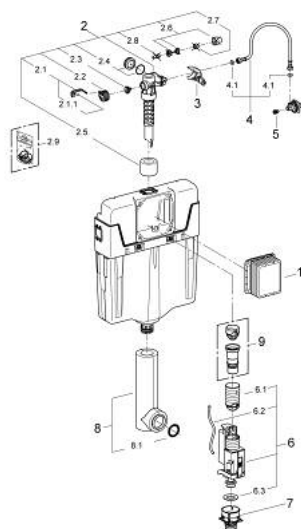

VARUOSAD, november 2012 – nüüd

- 1: Inspection shaft (Tellimuse number 66783000)
- 2: Filling valve (Tellimuse number 37095000)
- 2.1: Lever (Tellimuse number 43734000)
- 2.1.1: Seal (Tellimuse number 4377000M)
- 2.2: Valve head (Tellimuse number 43536000)
- 2.3: Membrane (Tellimuse number 4375800M)
- 2.4: Screw cap (Tellimuse number 43735000)
- 2.5: Valve float, 5 pcs. (Tellimuse number 4379100M)
- 2.6: Set of seals (Tellimuse number 43722000)*
- 3: Support device (Tellimuse number 42246000)
- 4: Tube (Tellimuse number 42233000)
- 4.1: Sealing washer (Tellimuse number 0319100M)
- 5: Headpart (Tellimuse number 42385000)
- 6: Dual Flush discharge valve AV1 (Tellimuse number 42320000)
- 6.1: Extension for overflow pipe (Tellimuse number 42313000)
- 6.2: Pneumatic hose (Tellimuse number 42319000)
- 6.3: Seal (Tellimuse number 42310000)
- 7: Valve seat for GD2 (Tellimuse number 42315000)
- 8: Flush pipe, concealed (Tellimuse number 43908000)
- 8.1: Sealing washer (Tellimuse number 4388000M)
- 9: 4.5 l adapter for GD2 (Tellimuse number 42333000)*

* Lisatarvikud