

37 751 001 TECTRON RETRO-FIT UNIT



TOOTE KIRJELDUS

- Värvus: chrome
- with infrared sensor for bi-directional communication for monitoring, configuration and service purpose
- 6 V lithium battery, type CR-P2
- battery lifetime: approx. 7 years (150 actuations a day)
- GROHE Long-Life finish
- exposed installation
- for concealed urinal flush valve 37 017 and DAL 509
- metal housing 145 x 90 x 45 mm
- solenoid valve with dirt strainer
- multistage battery status display
- 7 pre-set programs:
 - auto flush
 - cleaning mode
 - pre-flush on/off
- additional functions and precise settings by remote control 36 407
- adjustable flow time by hand or remote
- CE approved



37 751 001 TECTRON RETRO-FIT UNIT

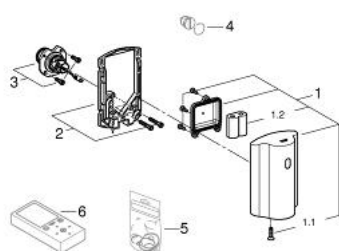

VARUOSAD, märts 2016 – nüüd

1: Housing electronic for 37 751 (Tellimuse number 42789000)

1.1: Fastening screw for 37751 (Tellimuse number 42788000)

1.2: Battery (Tellimuse number 42886000)

2: Mounting frame for 37751 (Tellimuse number 42790000)

3: Solenoid valve with strainer for 37 751 (Tellimuse number 42791000)

4: Supply stop (Tellimuse number 43392000)*

5: Set of seals for 37 751 (Tellimuse number 42792000)*

6: Remote control (Tellimuse number 36407001)*

* Lisatarvikud