

34 205 000 GROHTHERM 2000 SPECIAL THERMOSTATIC SHOWER MIXER 1/2"

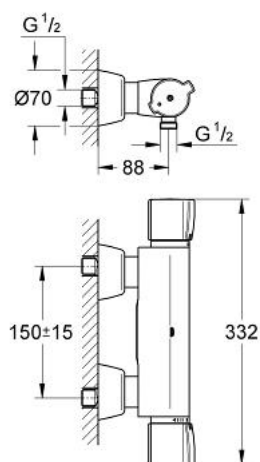

TOOTE KIRJELDUS

- Värvus: chrome
- wall mounted
- 100% GROHE CoolTouch consisting of safety housing + S-unions with CoolTouch escutcheons
- wing handles, made of metal
- GROHE TurboStat compact cartridge with wax thermoelement
- integrated mixed water shut off
- Carbodur ceramic headpart 1/2", 180°
- volume handle with individually adjustable economy stop
- temperature scale handle with pre-adjustable metal safety stop between 35°C and 43°C
- easy thermal disinfection with optional accessory handle 47 764 000
- shower bottom outlet 1/2"
- built-in non return valves
- dirt strainers
- covered S-unions
- protected against backflow
- GROHE Long-Life finish
- GROHE ErgoPlus
- GROHE SafetyPlus

34 205 000 GROHTHERM 2000 SPECIAL THERMOSTATIC SHOWER MIXER 1/2"

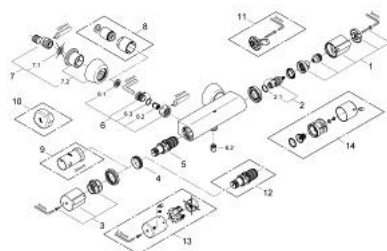

VARUOSAD, märts 2007 – nüüd

- 1: Handle for shut-off valve (Tellimuse number 47732000)
- 2: Ceramic headpart, 1/2" (Tellimuse number 45346000)
- 2.1: O-ring Ø 18.2 x Ø 1.7 (Tellimuse number 0392400M)
- 3: Temperature knob with metal end stop (Tellimuse number 47733000)
- 4: Fitting ring (Tellimuse number 47743000)
- 5: Thermostatic compact cartridge 1/2" (Tellimuse number 47439000)
- 6: Non-return valve (Tellimuse number 47189000)
- 6.1: Dirt strainer (Tellimuse number 0726400M)
- 6.2: Non-return valve (Tellimuse number 08565000)
- 6.3: O-ring Ø 17 x Ø 2 (Tellimuse number 0305500M)
- 7: S-union (Tellimuse number 12058000)
- 7.1: Seal (Tellimuse number 0138600M)
- 7.2: Covering escutcheon (Tellimuse number 45545000)
- 8: Extension set, 30 mm (Tellimuse number 46238000)*
- 9: Socket spanner (Tellimuse number 19332000)*
- 10: Unlocking handle (Tellimuse number 47764000)*
- 11: Handle for disabled use (Tellimuse number 47735000)*
- 12: GROHE TurboStat cartridge 1/2" (Tellimuse number 47175000)*
- 13: Metal handle temperature control (Tellimuse number 47763000)*
- 14: Handle for shut-off valve, metallic (Tellimuse number 07749000)*

* Lisatarvikud