

34 197 001 EUROPLUS E INFRA-RED ELECTRONIC BASIN MIXER 1/2" WITH MIXING DEVICE AND ADJUSTABLE TEMPERATURE LIMITER

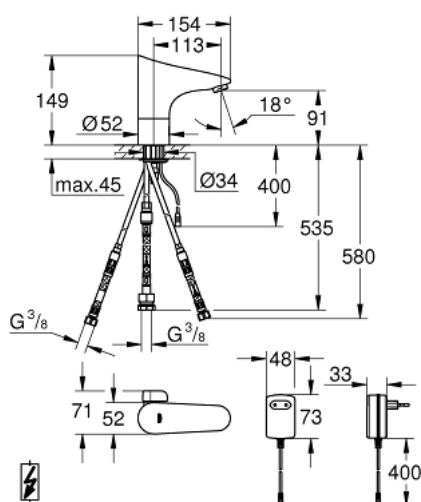

TOOTE KIRJELDUS

- Värvus: chrome
- with infrared sensor for bi-directional communication for monitoring, configuration and service purpose
- with plug transformer 100-230 V AC, 50-60 Hz, 6 V DC
- for open water heater
- GROHE Long-Life finish
- GROHE Water Saving - Less water, perfect flow
- fixed built-in static flow limiter on the hose connection
- flexible connection hoses
- dirt strainers
- solenoid valve
- rapid installation system
- 7 pre-set programs:
- CE approved
- type of protection faucet IP 59K

34 197 001 EUROPLUS E INFRA-RED ELECTRONIC BASIN MIXER 1/2" WITH MIXING DEVICE AND ADJUSTABLE TEMPERATURE LIMITER

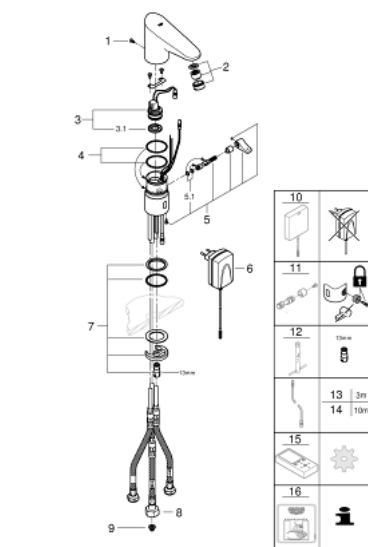

VARUOSAD, märts 2020 – nüüd

- 1: Screws (Tellimuse number 4283100M)
- 2: Flow straightener (Tellimuse number 46162000)
- 3: Solenoid valve (Tellimuse number 42475000)
- 4: Sealing washer (Tellimuse number 4283600M)
- 5: Mixer spindle with lever (Tellimuse number 42254000)
- 5.1: Mixing lever (Tellimuse number 42838000)
- 5.2: Sealing washer (Tellimuse number 4284000M)
- 6: Mains adaptor (Tellimuse number 42388000)
- 7: Fixing set (Tellimuse number 42841000)
- 8: Adapter with flow rate limiter (Tellimuse number 42255000)
- 9: Dirt strainer (Tellimuse number 0676800M)
- 10: Switch-mode power supply (Tellimuse number 36338000)*
- 11: Hidden mixing device (Tellimuse number 36209000)*
- 12: Mounting wrench (Tellimuse number 19017000)*
- 13: Power extension cable (Tellimuse number 36340000)*
- 14: Power extension cable (Tellimuse number 36341000)*
- 15: Remote control (Tellimuse number 36407001)*
- 16: Sticker with pictograph (Tellimuse number 4217700M)*

* Lisatarvikud