

## 29 165 LS0 GROHTHERM SMARTCONTROL THERMOSTAT FOR CONCEALED INSTALLATION WITH 3 VALVES

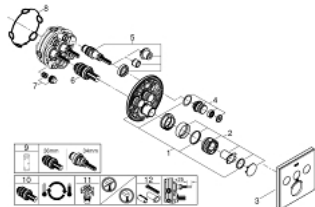

### VARUOSAD, september 2016 – nüüd

- 1: Mounting plate (Tellimuse number 48362000)
- 2: Temperature control handle (Tellimuse number 49029000)
- 2.1: Cover cap (Tellimuse number 1015030000)
- 2.2: handle adaptor (Tellimuse number 1015059990)
- 3: Escutcheon (Tellimuse number 49055LS0)
- 4: Push button (Tellimuse number 48361000)
- 4.1: pushbutton (Tellimuse number 14077000)
- 5: Cartridge (Tellimuse number 48359000)
- 5.1: Spindle (Tellimuse number 49088000)
- 6: Thermostatic compact cartridge 3/4" (Tellimuse number 49028000)
- 7: Non-return valves (Tellimuse number 47979000)
- 8: Seal (Tellimuse number 48360000)
- 9: Socket spanner (Tellimuse number 49059000)\*
- 10: GROHE TurboStat cartridge 3/4" (Tellimuse number 49003000)\*
- 11: Service stops (Tellimuse number 1405300M)\*
- 12: Universal extension set single-lever mixers, 25 mm (Tellimuse number 14048000)\*

\* Lisatarvikud