

26 075 EN0 EUPHORIA SYSTEM 310 SHOWER SYSTEM WITH THERMOSTATIC MIXER FOR WALL MOUNTING

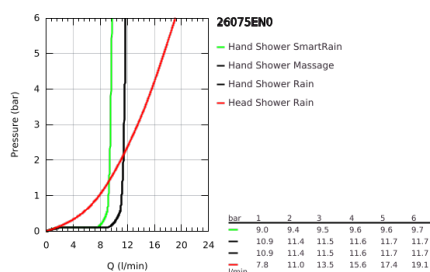

TOOTE KIRJELDUS

- Värvus: brushed nickel
- consisting of:
 - horizontal swivable 450 mm shower arm
 - exposed thermostat with Aquadimmer function
 - allows change between:
 - Rainshower Cosmopolitan 310 metal head shower
 - with ball joint
 - rotation angle $\pm 15^\circ$
 - hand shower Euphoria 110 Massage
- 3 spray patterns:
 - Rain, Massage, SmartRain
- maximum flow rate (at 3 bar): 13.5 l/min
- adjustable in height with gliding element
- Silverflex shower hose 1750 mm 1/2" x 1/2" (28 388)
- GROHE TurboStat compact cartridge with wax thermoelement
- GROHE SafeStop at 38°C
- GROHE SafeStop Plus optional temperature limiter at 43°C included
- GROHE MetalGrip ergonomically shaped metal handles
- GROHE DreamSpray perfect spray pattern
- GROHE Long-Life finish
- SpeedClean anti-lime system
- TwistStop to prevent hose from twisting
- suitable for instantaneous heaters from 18 kW/h
- minimum flow rate 5 l/min.
- optional upgrade: GROHE EasyReach tray (26 362)

26 075 EN0 EUPHORIA SYSTEM 310 SHOWER SYSTEM WITH THERMOSTATIC MIXER FOR WALL MOUNTING

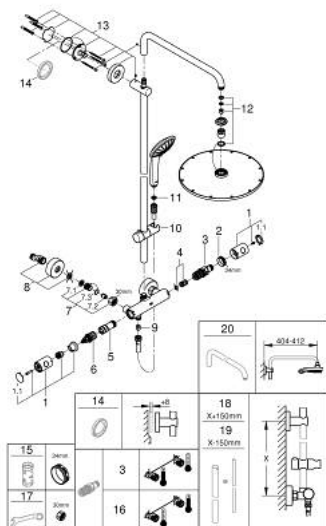

VARUOSAD, november 2016 – nüüd

- 1: Metal handle 1/2" (Tellimuse number 47984EN0)
- 2: Fitting ring (Tellimuse number 47743000)
- 3: Thermostatic compact cartridge 1/2" (Tellimuse number 47439000)
- 4: Buffer (Tellimuse number 47398000)
- 5: Water flow (Tellimuse number 47751000)
- 6: Aquadimmer (Tellimuse number 12433000)
- 7: Non-return valve (Tellimuse number 47189EN0)
- 8: S-union (Tellimuse number 12662EN0)
- 9: Non-return valve (Tellimuse number 08565000)
- 10: Glide element (Tellimuse number 12140EN0)
- 11: Dirt strainer (Tellimuse number 0726400M)
- 12: Spare part set (Tellimuse number 45933000)
- 13: Shower bar holder (Tellimuse number 48279EN0)
- 15: Socket spanner (Tellimuse number 19332000)*
- 16: GROHE TurboStat cartridge 1/2" (Tellimuse number 47175000)*
- 17: Special spanner (Tellimuse number 19377000)*

* Lisatarvikud