

22 917 000 **ATLANTA** ANGLE VALVE 1/2"

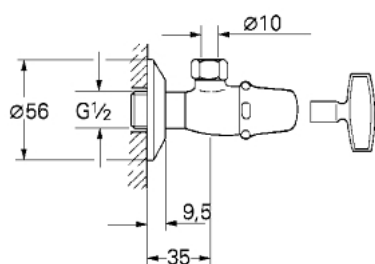

TOOTE KIRJELDUS

- Värvus: chrome
- wall connection 1/2"
- outlet 3/8"
- socket spanner headpart
- closed cap
- with compression nut Ø 10 mm
- marking: neutral
- sliding escutcheon
- GROHE Long-Life finish

22 917 000 ATLANTA ANGLE VALVE 1/2"

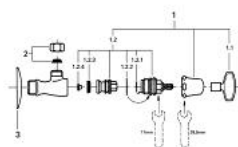

VARUOSAD, aprill 2008 – nüüd

- 1: Headpart 1/2" (Tellimuse number 11148000)
- 1.1: Socket spanner 1/2" (Tellimuse number 02277000)
- 1.2: Headpart 1/2" (Tellimuse number 07146000)
- 1.2.1: Sealing washer Ø 6 x Ø 2 (Tellimuse number 0128300M)
- 1.2.2: O-ring Ø 18.2 x Ø 1.7 (Tellimuse number 0392400M)
- 1.2.3: Seal (Tellimuse number 0529100M)
- 2: Compression union 3/8" (Tellimuse number 1291400M)
- 3: Escutcheon 1/2" (Tellimuse number 02201000)