

## 20 179 001 **COSTA S PILLAR TAP**

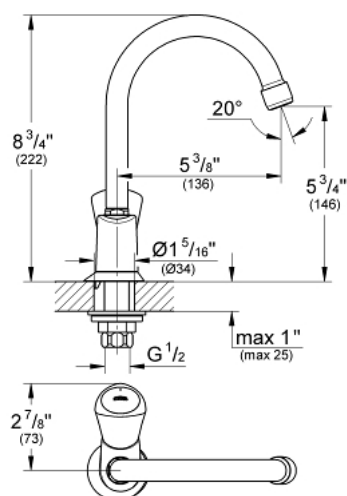

### TOOTE KIRJELDUS

- Värvus: chrome
- metal handle
- heat-insulated
- screwable
- GROHE Long-Life finish
- ceramic headpart 1/2", 90°
- flow straightener
- swivel tubular spout
- swivel area 360°
- union nut 1/2" with 10.5 mm drilling



## 20 179 001 **COSTA S PILLAR TAP**

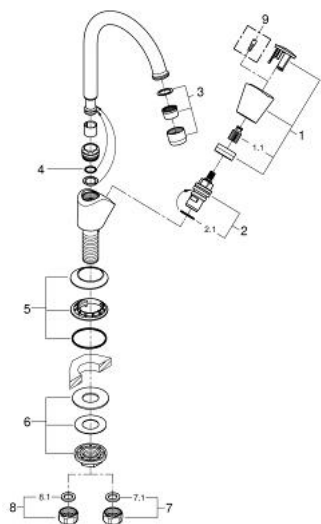

### **VARUOSAD**, aprill 2014 – nüüd

- 1: Handle (Tellimuse number 45995000)
- 1.1: Snap insert (Tellimuse number 0538600M)
- 2: Ceramic headpart, 1/2" (Tellimuse number 45882000)
- 2.1: O-ring Ø 18.2 x Ø 1.7 (Tellimuse number 0392400M)
- 3: Mousseur (Tellimuse number 48251000)
- 4: O-ring Ø 12 x Ø 2 (Tellimuse number 0128000M)
- 5: Escutcheon (Tellimuse number 45996000)
- 6: Shank mounting kit (Tellimuse number 45004000)
- 7: Coupling nut 1/2" (Tellimuse number 1290100M)
- 7.1: Fibre seal Ø 18,5 x Ø 12 x 2 (Tellimuse number 0138900M)
- 8: Coupling nut 1/2" x 14.5 mm (Tellimuse number 1290200M)
- 8.1: Fibre seal Ø 18,5 x Ø 12 x 2 (Tellimuse number 0138900M)
- 9: Screw for Costa/Avina products (Tellimuse number 48013000)\*

\* Lisatarvikud